



... wie im Original

**Specialist in
Model Landscaping**

**New Items
2023**



Themed Figures Sets



Trees XL Sets



Abandoned Place 'Locomotive'



micro-motion Skatepark



Easy-Track Railway Route Kit 'Theisensee'

With novelties of our partner KATO

**Focus Theme 2023
'City, Country, River!'**

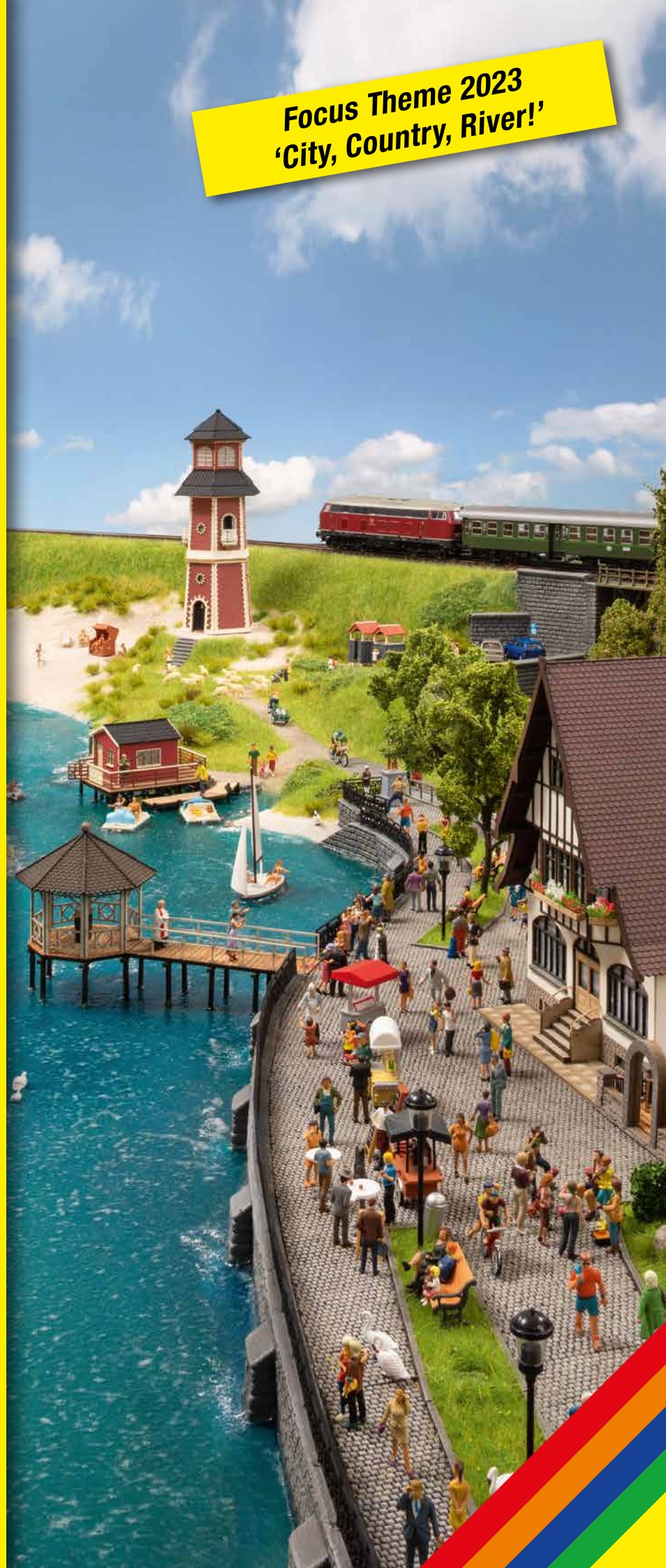

'City, Country, River!'

HO, TT and N Figures



The popular German game 'City, Country, River!' lends its name to our new items this year. Get inspired by our new Figures for your modelling projects. Already available at your local dealer.



- HO** 15080 Traffic Accident NEW
- TT** 45080 Traffic Accident NEW
- N** 36080 Traffic Accident NEW



- HO** 15217 Passengers NEW
- TT** 45217 Passengers NEW
- N** 36217 Passengers NEW



- HO** 15238 People on Benches NEW



- HO** 15246 At the Bus Stop NEW
- TT** 45246 At the Bus Stop NEW
- N** 36246 At the Bus Stop NEW



- HO** 15284 Shunters NEW
- TT** 45284 Shunters NEW
- N** 36284 Shunters NEW



- HO** 15523 People in the Rain NEW



- HO** 15598 Gardening NEW



- HO** 15599 Family Having a Picnic NEW

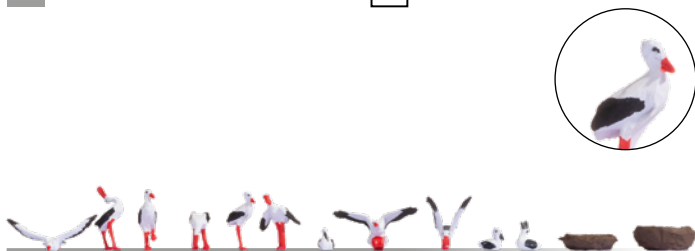

- HO** 15776 Storks NEW



- HO** 15889 Skateboarders NEW



H0 15909 Family on a Bike Ride

NEW



H0 15948 Artists and Nude Models

NEW



H0 15762 Draught Horses

NEW

TT 45762 Draught Horses

NEW

N 36762 Draught Horses

NEW

Marcel Raschka
Purchasing

The Figures fit many different everyday situations in everyone's life perfectly! I like 'People in the Rain' the best.



H0 15728 Highland Cattle

NEW

'Alle Jahre wieder ...'

H0, TT and N Gauge Figures Advent Calendar



With its beautiful cover picture, the Figures Advent Calendar in A3 Landscape is an absolute eyecatcher. You can look forward to a new figure when you open a little door every day – an ideal gift for any modeller!

Expected release: October 2023

Note: There are model railway figures in the calendar, but no winter or Christmas figures. Further information on the new Figures Advent Calendar will be published in autumn 2023.



Colour 3D Print – That’s Never Happened Before!



3D Master Figures for N and Z Gauge

3D 3D print is evolving rapidly, and new technologies are opening up a wide range of possible uses for our lovely hobby.

The new NOCH 3D Master Figures are 3D printed and in colour! Even the smallest details become visible with this fantastic technology. Whether checked shirts, striped blouses or colour grading and gradients, full-colour 3D printing makes it possible.

Expected release: June 2023

Top Innovation!

Dr. Rainer Noch
Managing Director

It's a minor sensation: our new coloured Model Figures come from the 3D printer. It's the kind of technology that is fascinating and opens up great new possibilities.



N 35000 Fire Brigade **NEW**
Z 44500 Fire Brigade **NEW**



N 35050 Construction Workers **NEW**
Z 44501 Construction Workers **NEW**



N 35200 Railway Officials **NEW**
Z 44510 Railway Officials **NEW**



N 35250 Shunters **NEW**
Z 44511 Shunters **NEW**



N 35300 Passengers **NEW**
Z 44520 Passengers **NEW**



N 35400 Sitting People **NEW**
Z 44521 Sitting People **NEW**



N 35800 Bathers **NEW**
Z 44530 Bathers **NEW**



N 35820 Mountain Hikers with Cross **NEW**
Z 44531 Mountain Hikers with Cross **NEW**



Z 44540 Cows NEW



Z 44541 Deer NEW



Z 44542 Horses NEW



Stone on Stone

Handpainted Plastic Walls for TT and N



The small walls are very well suited to enclosing properties and courtyards or demarcating fields. Many different installation setups may be mastered using the individual wall parts and pillars. The walls can be cut with a hand saw and affixed with superglue or hot glue.

They are realistically handpainted. Each set contains twelve parts: four wall elements each with a pillar, three wall elements without a pillar and five individual pillars.

Expected release: June 2023



N 33170 Quarrystone Wall NEW
12 parts, total length 39 cm, wall height 0.9 cm
pillar height 1.2 cm

TT 43170 Quarrystone Wall NEW
12 parts, total length 51,5 cm, wall height 1.2 cm
pillar height 1.6 cm



N 33171 Fieldstone Wall NEW
12 parts, total length 39 cm, wall height 0.8 cm
pillar height 1.2 cm

It's All Happening in the Station District!

H0 Themed Figures Sets



The popular NOCH Themed Figures Sets consist of finely detailed decoration accessories as well as matching figures. For this year's focus theme of 'City, Country, River!', six new, handpainted sets with scenes in the city (mostly in the station district or the immediate vicinity), are being released.

Have fun decorating!

Expected release: November 2023

Tip: visit the Themed Figures Sets on our website at www.noch.com. There you will find many further decoration ideas for the individual scenes.

Sonja Bernhard
Key Account
Management

The themed worlds are ideal, because they contain all the figures and accessories to make a scene look even more vibrant.



Themed Figures Set
'Roadworks'



Themed Figures Set 'Roadworks'

Kalle, Bodo and Bob are particularly motivated today, lugging buckets, operating a jackhammer, and compacting the ground. Their colleagues, however, are not in such a rush. First making a call, leaning on the broom for a bit, and waiting around. But then, with combined forces, things really move forward! A lack of work tools shouldn't be a problem, because we've packed enough of them in the theme!

H0

16262 Themed Figures Set 'Roadworks'

NEW

Contents: 6 construction workers
4 large construction site barriers
4 small construction site barriers
5 beacon stands
2 beacons on stands
4 traffic cones ('witches' hats)
1 wheelbarrow
1 shovel
1 broom



Themed Figures Set 'Police Operation'

The six friendly police officers and the police dog always go into action wherever law and order must be ensured. With the crowd control barriers, floodlights and generator, they can be called to secure a demonstration or maintain order at a rock concert. To be on the safe side, we have also included two speed cameras in the theme so that everything needed for the next vehicle spot check is there!

HO 16260 Themed Figures Set 'Police Operation'

NEW

- Contents:
- 6 police officers
 - 1 police dog
 - 4 police barriers
 - 4 lightweight crowd control barriers
 - 1 floodlight
 - 1 power unit
 - 2 speed cameras
 - 1 traffic sign



Themed Figures Set 'Post'

It's not just since the online shopping excesses during the corona pandemic that we have realised how important the boys and girls from the postal service are to us. They deliver letters and parcels safely to their recipients in all kinds of weather. Could there even be a NOCH product inside? They are also yellow like Deutsche Post! Anyone who wants to provide more (model) parcel arrivals can take a look in the NOCH online shop at www.noch.com!

HO 16265 Themed Figures Set 'Post'

NEW

- Contents:
- 1 postman
 - 3 parcel couriers
 - 1 postman on a bicycle
 - 1 postal trolley
 - 2 postman trolleys
 - 1 bicycle
 - 1 cargo bike
 - 1 platform trolley
 - 2 different postboxes



Themed Figures Set
'Loading Goods'



Themed Figures Set 'Loading Goods'

They're knuckling down to work here! Warehousemen and hauliers have their hands full. Crates have to be moved, barrels stored, and many other goods transported. It's good to have a colleague or two from logistics to keep track of things and know what has to go where. With the goods and matching figures, you can decorate beautiful and vibrant scenes at goods yards, logistics centres, loading bays and factory courtyards in your model landscape.

H0

16266 Themed Figures Set 'Loading Goods'

*Contents: 1 warehousewoman with sack truck
1 warehouseman with crate
1 warehouseman with hand pallet truck
2 warehousemen and 1 haulier
1 hand pallet truck, 1 sack truck
1 pallet (empty), 2 pallets with load
1 pallet cage on pallet, 1 small crate
4 different barrels
4 different gas bottles*

NEW

G

1

0

H0

TT

N

Z



Themed Figures Set 'Platform'

The platform is the hub of any model railway layout. True dramas play out here between ticket machines, benches and timetables! Is the train on time? Is it coming at all, and if so, does it go all the way? So the little NOCH people on the platform can wait for the answers as comfortably as possible and reach their destination safely, we have added benches, a ticket machine and many other accessories to the set! Let your imagination run wild when decorating!

- HO 16268 Themed Figures Set 'Platform'**
- Contents: 5 passengers
 - 2 suitcases
 - 1 ticket machine
 - 1 ticket validator
 - 1 train status/timetable display board
 - 1 grid trolley
 - 3 luggage trolleys
 - 1 sign
 - 2 three-seater benches

NEW



Themed Figures Set 'Rail Depot'

The rail depot is an absolute dream subject for every railway modeller. No matter whether it's the XL version for iron horses with turntables, a water tower, coal feeding and an inspection pit or 'just' a small siding where the diesel locomotive is refuelled and repaired: with the right decoration, these scenes really come to life. The Themed Figures Set provide small standard equipment for the depot that everyone can use!

- HO 16270 Themed Figures Set 'Rail Depot'**
- Contents: 1 worker sitting on a cable drum
 - 1 crane operator
 - 1 worker with brake shoe
 - 1 worker with shovel
 - 1 foreman
 - 1 hand crane, 2 cable drums
 - 4 barrels
 - 1 brake shoe stand
 - 1 welding carriage

NEW



Available exclusively at participating NOCH dealers from October 2023. More info from September 2023 at www.noch.com



Duc Tiet Quang
Production Manager
NOCH Asia

Developing these themed Figures XL Sets gave me a great deal of pleasure. Affordable products in environmentally friendly packaging!

Finally Available Again!

Figures XL Sets



The extremely popular Figures XL Sets are finally available again. The practical sets each contain at least 18 elaborately handpainted individual figures, matching a theme. You can choose from eight interesting themes: from 'Passengers' to 'At the Station' to 'In the Mountains', all the important model railway topics are included.

Worth mentioning: the XL Sets are packaged in an environmentally friendly way.

The new sustainable figures packaging consists of 100% card and can therefore be disposed of without any problems.

The new Figures XL Sets will be available from October 2023 exclusively at dealers participating in the NOCH Season Promotion. From September, you can find out which dealers are participating on our website, www.noch.com.

Expected release: October 2023



HO 16106 XL Set 'Passengers', 18 figures

NEW



HO 16111 XL Set 'At Work', 18 figures

NEW

Best Value!



H0 16122 XL Set 'At the Station', 18 figures

NEW



H0 16125 XL Set 'In the City' (without bench), 19 figures

NEW



H0 16131 XL Set 'Sitting People' (without benches), 18 figures

NEW



H0 16140 XL Set 'In the Mountains', 18 figures

NEW



H0 16162 XL Set 'Sheep and Shepherd', 37 figures

NEW



H0 16164 XL Set 'Black & White Cows', 21 figures

NEW

A Lot of Tree for Little Money

Trees XL Sets 'Classic Trees'



The attractive card boxes each contain five "Deciduous Trees" or eight "Fir Trees" from the popular, high-quality Classic tree series. With these lovely sets, you can reforest your model landscape with great trees at a reasonable price. While developing the new carton packaging, we paid particular attention to sustainability. The entire packaging is plastic-free and can therefore easily be recycled.

In addition, with the new Trees XL Sets, we are continuing a nice tradition that we started years ago with the Economy Sets. For every 100 model trees sold, the 'Plant-for-the-Planet' organisation plants one real tree on our behalf. Thanks to your support, we have already been able to plant more than 6,000 trees through this initiative over the past few years.

Expected release: May 2023

Saver Packs – Trees at a Particularly Affordable Price!



H0 TT N Z 25610 Fruit Trees NEW
5 pieces, approx. 8 cm high



H0 TT N Z 25615 Fruit Trees, Blossoming NEW
5 pieces, approx. 8 cm high



H0 TT N Z 25620 Deciduous Trees NEW
5 pieces, approx. 8 cm high



Melanie Haas
Sales Assistant
International

The very realistic
appearance of the Classic Trees
enhances any layout.



H0 TT N Z

25625 Autumn Trees

5 pieces, approx. 8–10 cm high

NEW



H0 TT N Z

25630 Birch Trees

5 pieces, approx. 10 cm high

NEW



H0 TT N Z

25635 Poplar Trees

5 pieces, approx. 12 cm high

NEW



H0 TT N Z

25640 Fir Trees

8 pieces, approx. 8–12 cm high

NEW

Getting Wet!

Lake Film

You can design custom lakes and ponds with the transparent Lake Film. Since the film is not pre-dyed, you can design the lakebed in a colour of your choice. For this, we recommend the Waters Colour Set (ref. 60878).

Expected release: March 2023



60852 Lake Film

transparent, with wave shape
41 cm x 26 cm

NEW



Mini Grass Mats for Quick and Uncomplicated Use!

NOCH Mini Grass Mats are particularly suitable for adding greenery to small areas. For this purpose, you can simply cut them to size with scissors or a craft knife and then stick them in the desired place. Ideal for railway modellers, Nativity and diorama builders.

Already available at your local dealer.

Tip: we recommend NOCH Grass Glue (ref. 61130 and 61131) for glueing.

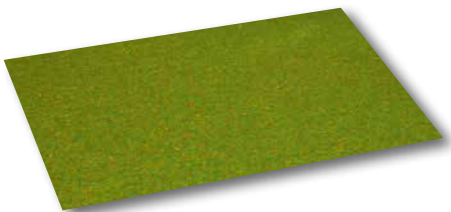
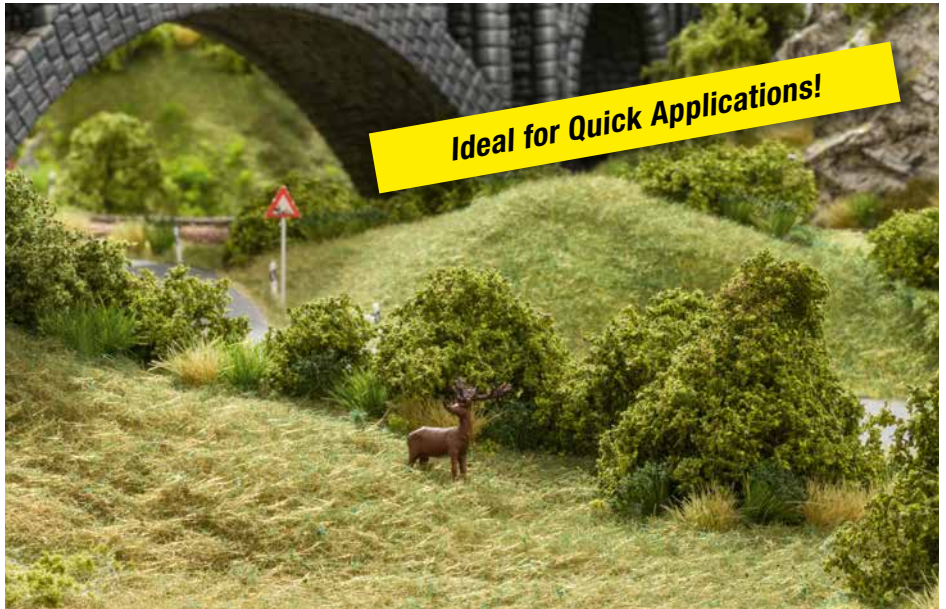

00008 Mini Grass Mat 'Flower Meadow'

45 cm x 30 cm, set with 4 pieces

NEW

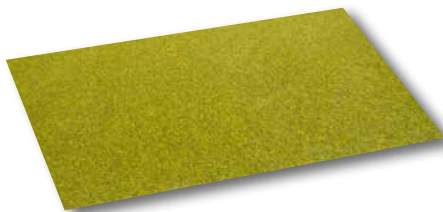

00007 Mini Grass Mat 'Meadow'

45 cm x 30 cm, set with 4 pieces

NEW



00006 Mini Grass Mat 'Spring'

45 cm x 30 cm, set with 4 pieces

NEW



Marc Siebenrock
Order Fulfilment

With Wrinkle Rocks XL, large rock structures can now become real hits on your model railway layout. Creating a formidable rocky landscape in a short time is easy-peasy.

'Are You Still Plastering or Already Crinkling?'

Wrinkle Rocks XL: The Original, Now Even Bigger!

Product Highlights:

- Super simple application
- Photorealistic look
- High-quality special paper
- Lightweight construction
- Knitterfelsen® from Austria – THE original!



Wrinkle Rocks by Andreas Dietrich, the inventor from Austria, are now joining the NOCH range in XL format. The three most popular rock structures come in the size 61 cm x 34.5 cm. Application is extremely simple and promises realistic results in your model landscape. The Wrinkle Rocks can be secured with hot glue or NOCH Landscaping Glue (ref. 61133).

Expected release: March 2023



O HO TT N

NEW

60307 Wrinkle Rocks XL 'Wildspitze'
 61 cm x 34.5 cm



O HO TT N

NEW

60309 Wrinkle Rocks XL 'Großvenediger'
 61 cm x 34.5 cm



O HO TT N

NEW

60311 Wrinkle Rocks XL 'Seiser Alm'
 61 cm x 34.5 cm



Craft Tip:
 Knitterfelsen®



1. The Wrinkle Rocks are wrinkled, crumpled and creased!



2. This produces an easy to shape and three-dimensional rock structure.



3. The Wrinkle Rocks are built into the landscape.



Stefanie Albert
Personnel Officer

Lost places can be found all over the world and represent a long-forgotten story. At NOCH, we're reviving the past.

Lost Places: Witnesses of Times Long Forgotten ...

Abandoned Place 'Locomotive'



After the great success of the Abandoned Places last year, we have another great model for this year to add to the series. A decayed locomotive is every railway fan's nightmare. Or maybe not? Who knows. With the help of a few friends and some hard work, you

could set up an association and get the locomotive back on the rails. A little bit of repairing, welding, sanding and hammering will be required. But the old iron horse will soon look like new again.
Expected release: July 2023

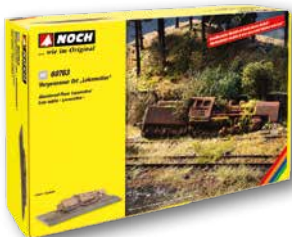

H0 60763 Abandoned Place 'Locomotive'
 Contents: Base plate with locomotive made from NOCH Hard Foam
 24 cm x 10.1 cm x 5.2 cm high



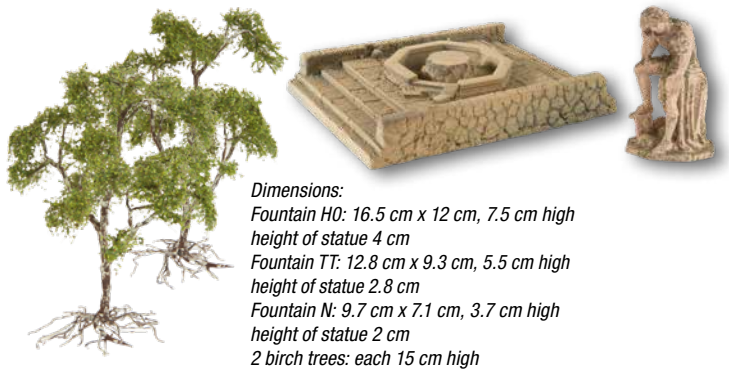

Dimensions:
 Fountain HO: 16.5 cm x 12 cm, 7.5 cm high
 height of statue 4 cm
 Fountain TT: 12.8 cm x 9.3 cm, 5.5 cm high
 height of statue 2.8 cm
 Fountain N: 9.7 cm x 7.1 cm, 3.7 cm high
 height of statue 2 cm
 2 birch trees: each 15 cm high

HO 60760 Abandoned Place 'Fountain'
 Contents: Fountain made of NOCH Hard Foam with statue,
 2 'Birch Tree' twisted wire trees

TT 48001 Abandoned Place 'Fountain'
 Contents: Fountain made of NOCH Hard Foam with statue,
 2 'Birch Tree' twisted wire trees

N 34760 Abandoned Place 'Fountain'
 Contents: Fountain made of NOCH Hard Foam with statue,
 2 'Birch Tree' twisted wire trees



HO 60761 Abandoned Place 'Ruins of a Building'
 Contents: Ruins of a Building made of NOCH Hard Foam
 16.5 cm x 12.1 cm, 6.5 cm high with weathered tractor
 1 'Lime Tree' twisted wire tree, 16 cm high

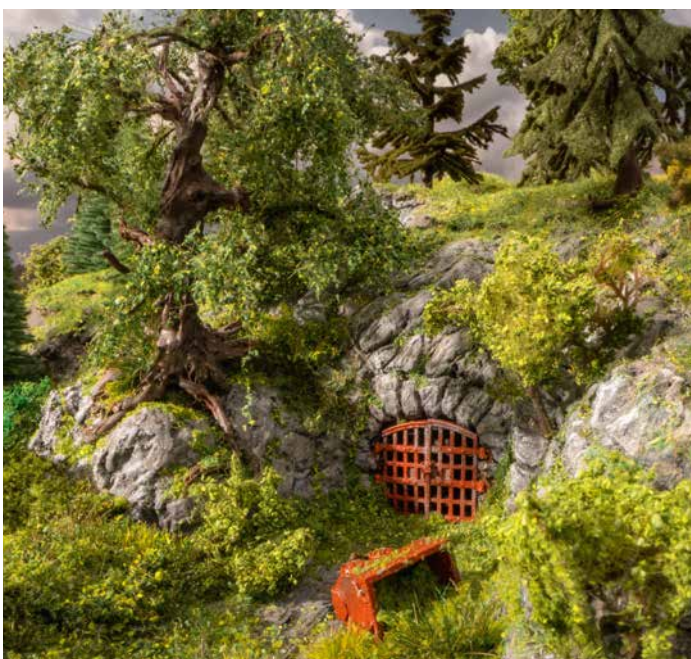

HO 60762 Abandoned Place 'Adit'
 Contents: Adit made of NOCH Hard Foam with neglected gate
 16.5 cm x 12.2 cm, 8.3 cm high and old trolley
 1 'Oak Tree' twisted wire tree, 17 cm high

Highlight Model Fitting the Annual Focus Theme of 'City, Country, River!'



We Can Finally Go Back Outside, Meet Up with Friends and Enjoy Life Together!

Laser-Cut Kit Tavern with Beer Garden



In the last few years, we've all truly realised that getting together with friends and the carefree enjoyment of life is invaluable. That's why we consciously decided on an inn with a beer garden for the focus theme of

'City, Country, River!' this year and thus want to bring a little piece of the 'perfect world' to your model landscape.

The model was inspired by the 'Wirtshaus am See' in Bregenz at Lake Constance and realised as a Laser-Cut kit. Alongside the beautiful architecture, the romantic timber framing in particular determines its appearance and transforms the building into an absolute eyecatcher.

A detailed Instructions and special Laser-Cut Adhesive are included.

Expected release: June 2023



- HO** 66401 Tavern with Beer Garden **NEW**
- N** 63401 Tavern with Beer Garden **NEW**

Made in Germany 



Suitable figures for designing the scene:



H0 16246 Themed Figures Set 'Restaurant'
Contents: 5 sitting patrons and 1 dog, 1 waiter, 1 large 'chef' advertising mascot, 4 tables, 6 chairs, 1 serving trolley, 1 menu stand with menu



H0 14822 Restaurant
Contents: 8 chairs, 5 tables and 1 A-board



H0 15838 Restaurant

Note: you'll find matching Laser-Cut minis to design your model scene on page 21.



... Just like the original! The model was inspired by the paragon in Bregenz at Lake Constance.

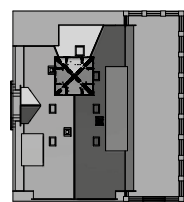

H0 Gauge:
18.9 cm x 17.2 cm, 18.5 cm high
N Gauge:
10.3 cm x 9.4 cm, 10.1 cm high



Info tip:
Incidentally, NOCH Laser-Cut Kits are particularly sustainable because they're made from renewable raw materials and the energy for lasering is used highly efficiently. Our packaging will undergo another improvement with the introduction of new items in 2023. We will reduce the plastic content by means of a new packaging design.



Video clip

With Realistic Rotating Light Signal!



We Finally See the Light!

Lighthouse with Light Signal



The clinker-brick lighthouse not only goes well with the sea but is also a welcome sight to skippers in every port and estuary on stormy nights. As a highlight, the NOCH Laser-Cut Kit comes with a realistic motorised light signal. As a result, the so-called beacon rotates realistically in a circle.

The electronics are ready for installation. Connect to a standard 16 V model railway transformer. Suitable for AC and DC. Instruction and special Laser-Cut Adhesive are included.

Expected release: September 2023

Montserrat Garcia Export
Ahoy! I come from the sea and love the sunsets on the endless water just before the beacon shows sailors the way in the dark...

Suitable figures for designing the scene:



HO 15854 Water Sports



HO 15749 Sheep



6.9 cm x 8 cm, 18.4 cm high



HO 66831 Lighthouse with Light Signal

NEW

Laser-Cut minis for 'City, Country, River!'



The Laser-Cut minis Kits blend in perfectly with our annual focus theme: the Lifeguard Tower and Boat Hire are ideal for use on a river, a lake or even at the sea.

And since model-building should above all be fun, we have also given

the lifeguards a little 'task'. Another special feature is the Event Pavilion "Fischersteg", which was inspired by the paragon of the same name.

Expected release: May 2023



... Just like the original! The Fischersteg was inspired by the paragon in Bregenz at Lake Constance.



H0 14264 Event Pavilion „Fischersteg“ **NEW**
12.9 cm x 5.2 cm, 7.1 cm high

N 14619 Event Pavilion „Fischersteg“ **NEW**
6.8 cm x 2.8 cm, 3.9 cm high



H0 14265 Lifeguard Tower with shark fin **NEW**
5.6 cm x 4.5 cm, 5.3 cm high



H0 14259 Boat Hire **NEW**
9.2 cm x 7.3 cm, 5.3 cm high



H0 14208 Simple Railings **NEW**
8 railings each in green, grey, brown; total length per colour: 64 cm



H0 14209 Wrought Iron Railings **NEW**
12 pieces, total length 111.6 cm



H0 13751 Power & Distribution Boxes **NEW**
6 pieces
2 x 1.2 cm x 1.2 cm, 1.8 cm high
2 x 0.4 cm x 2.3 cm, 1.8 cm high
2 x 0.3 cm x 0.7 cm, 1.5 cm high



H0 14237 Large Concrete Slabs **NEW**
40 pieces, 2.3 cm x 2.3 cm

TT 14429 Large Concrete Slabs **NEW**
40 pieces, 1.7 cm x 1.7 cm

N 14629 Large Concrete Slabs **NEW**
40 pieces, 1.3 cm x 1.3 cm

Tip: The TT and N concrete slabs can each also be used as 'small' plates for the larger gauges.



Azariah Mertens Modeller
I associate the Event Pavilion with a beautiful sunset romance realised in a model!

Jump Around: 90s Vibes in a Halfpipe!

H0 micro-motion Skatepark



Anyone who's anyone in the skateboarding community meets in the skatepark! The six characters included in the kit are

competing in a skate battle, outdoing each other with tricks and cool jumps! Thanks to the micro-motion drive, the best female skater rides and jumps over the halfpipe model and lands safely again.

The "Skatepark" is designed as a laser-cut kit. The electronics that move the skater are ready to connect to a standard 16 V model railway transformer and are suitable for AC and DC. Six highly detailed, colour-printed figures are included in the set for decoration.

The model is limited to 1000 copies. A numbered certificate, detailed instructions and special Laser-Cut Adhesive are included.

Expected release: November 2023

Note: other suitable skater figures for decoration can be found on page 3 in this leaflet.



H0 66834 micro-motion Skatepark



Contents:

Laser-Cut Kit 'Skatepark'

6 exclusive, colour-printed figures, one of them for use in the halfpipe

Micro-motion drive

Numbered certificate

Detailed instructions

Special Laser-Cut Adhesive





Video clip



Sebastian Topp
Managing Director

The Skatepark reminds me of lots of great episodes from my early adolescence! Developing it as a team was a joy.



Six highly detailed, coloured printed figures included.

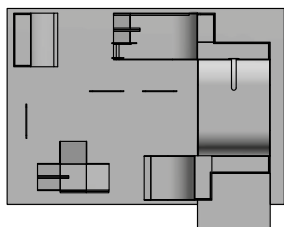

29.7 cm x 23.6 cm
7.3 cm high



Small but Powerful!

H0 NOCH Easy-Track Railway Route Kit 'Theisensee'

Our partner, the professional layout builder Andreas Theis, has done it again. This time, the task was to develop a compact layout with an interesting track plan and exciting possibilities for landscaping. We think he's done an excellent job!

The Easy-Track Railway Route Kit 'Theisensee' opens up the possibility for railway modellers to build a custom H0 model railway layout on a compact area of only 125 cm x 105 cm.

This layout's small size and ease of transport are not the only advantages, because the ingenious track plan contains a siding that can be driven on from both sides and on which a unit train can be parked. This means that a second train can travel undisturbed on the main line. A short siding enables shunting operations. If the layout is to be expanded, this siding connects the new and the previous part of the layout.

Of course, bridges and underpasses can also be installed: the point of intersection contained in the track plan is particularly suitable for a bridge and gives the landscape a special eyecatcher.

The topic of winter landscapes is becoming more and more popular in landscape modelling. That's why Andreas Theis built his latest piece as a winter layout. On the following double page, you will find an interpretation by our modeller Azariah Mertens, who designed this as a summer layout. You need to look closely to allocate the same track plan to the two layout variants.

Expected release: October 2023



Contents:

- 1:1 plot track plan
- 1 Easy-Track 'Andrestal' Guidebook
- Track plans for Märklin® C-/K-Track, TRIXX C-Track, PIKO A-Track and Roco Line without track bed
- 43 pillars; maximum pillar height 17.4 cm, minimum pillar height 9.2 cm
- 10 circle segments, 60°, 8 cm wide
- 2 circle segments, 45°, 8 cm wide
- 8 straight lane segments, 8 cm wide
- 2 point modules, route connector modules, wood screws



Info Tip:

You can find many more Easy-Track Railway Route Kits for H0 and N in the NOCH catalogue and at www.noch.com.





H0 53615 Easy-Track Railway Route Kit 'Theisensee'

Outer dimensions of constructed routes:

123 cm x 103 cm, 17.4 cm high

Minimum floorspace required for assembly:

125 cm x 105 cm



easy
TRACK®



Development and Modeller
Andreas Theis
'Winter' version

This Is Easy-Track



Easy-Track is a model railway reconceptualised, because Easy-Track relieves you of the time-consuming steps of track planning. You immediately start building your personalised dream layout in the size of 125 cm x 105 cm.

Easy-Track contains everything you need to get cracking on building the track layout: the tracks for your custom model railway layout are already pre-cut and the pillars for the route only have to be stuck together. Even a 1:1 layout plan is included in the kit. Finally, detailed instructions illustrate how to assemble the Easy-Track railway route system. And of course all the important track plans are included in the Railway Route Kit. All you need are rails from the manufacturer of your choice and a base plate. Thanks to the well thought out Easy-Track system, building your track layout goes off without a hitch.

The Easy-Track Railway Route Kit 'Theisensee'

The summer version of the compact 'Theisensee' layout, measuring just 125 cm x 105 cm, is put in the spotlight on this double page.

Our modeller Azariah Mertens has constructed this harmonious summer landscape.

Compare the summer and winter variants: isn't it fascinating how many avenues the Easy-Track system opens up for customising your model landscape?



Product Highlights:

- Easy-Track Railway Route Kit 'Theisensee'
- 125 cm x 105 cm
- With Easy-Track 'Andreastal' Guidebook
- With H0 track plans for Märklin® C-/K-Track
TRIX C-Track, PIKO A-Track
Roco Line without track bed



Video clip

How to Build Your Custom Model Railway Layout with Easy-Track

In the Easy-Track Guidebook, you'll learn how an Easy-Track layout is built step by step, using the example of the 'Andreastal' (ref. 53605) layout. Our author Andreas Theis planned the layout and documented its construction with photographs.

He guides you through assembly of the Easy-Track railway route system in comprehensible individual steps, from

laying the tracks to model landscaping and landscape design and decoration, to the finished layout.

The 124-page Easy-Track guidebook is included in the kit.

You can also get hold of it at www.noch.com or from your NOCH trade dealer.





Pre-Announcement for Autumn 2023: Easy-Track Individual

In 2020, we presented the first Easy-Track layout with the Easy-Track Railway Route Kit 'Karlsberg' (ref. 53600). The response to the innovative system was overwhelming, because Easy-Track solves many problems of track planning and route construction. In the meantime, four different H0-gauge layout kits and one N-gauge layout kit have been made available (further info in the NOCH catalogue or at www.noch.com).

Since the first kit was introduced, we have received encouragement from countless railway modellers to further develop the Easy-Track system so that it can also be used to build customised railway routes. And that's what we've done. We have developed new parts for the Easy-Track system that enable flexible, customised railway route construction.

We look forward to announcing the launch of Easy-Track Individual in autumn 2023. With the help of an ingenious system of stands, flexible pillars and pre-cut tracks, Easy-Track Individual allows you to assemble your own custom route.

Maria Kempter
Online Marketing

The Easy-Track 'Theisensee' layout shows how a sophisticated, versatile layout can be designed in a compact way.



NOCH Modeller
Azariah Mertens
'Summer' version

Reissue: Glacier Express

NEW Starter Set Glacier on Tour

All-in-one starter set!

Simply unpack and install – done!!

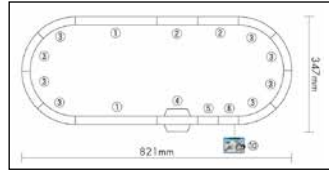

Starter Set Glacier on Tour

NOCH Ref.	KATO Ref.	Description	Gauge
7074067	10-021	2 x Straight Track, 248 mm 2 x Straight Track, 124 mm 8 x Curved Track, R150-45° Open Railway Crossing, 124 mm Straight Track, 62 mm Straight Feeder Track, 62 mm Feeder Cable Rerailer Rail Joiner, Removal Tool Power Pack (speed controller) Locomotive (new motor) Panorama Coaches	N

Glacier Express: The World's Slowest Express Train

NEW A panoramic journey through the Swiss Alps in the Glacier Express leaves an impression – with highlights at the beginning and the end. The world of the rich and beautiful greets you in St Moritz, the mountain air in Davos, and the most photographed mountain, the Matterhorn, in Zermatt. The Glacier Express is the most famous railway in the world. It takes about seven hours to travel through untouched mountain landscapes, chic spas, deep gorges, delightful valleys, 91 tunnels and over 291 impressive bridges.

Expected release: May 2023

Model Features of the Coaches:

- Minimum radius: R150
- Outer dimensions: approx. 118 mm x 18 mm
- Weight: approx. 20 g
- Wheel diameter: 4.6 mm
- Arnold couplings
- KATO standard interior lighting not possible due to panoramic windows

Model Features of the Locomotive:

- Minimum radius: R150
- Maximum incline: 4%
- Outer dimensions: approx. 103.1 mm x 19 mm x 24.4 mm
- Weight: approx. 79 g
- Wheel diameter: 6.8 mm
- Drive: SL3 motor; slower, quieter, more realistic
- Arnold couplings
- Operating headlights
- Digitisation with Digitrax decoder possible (ref. 70DN63K4A)

Expected release: May 2023



NOCH Ref.	KATO Ref.	Description	Gauge
7074068	10-1816	Basic Set Glacier Express, 3 pcs.: Locomotive Ge4/4 III #644 Panorama Car 1st class Ap1314 Panorama Car 2nd class Bp 2535 3 x UNITRACK track straight, 124 mm (ref. 7078003), 1 pcs. rerailer	N
7074031	10-1146	Add-on Set Glacier Express, 4 pcs.: Panorama Car 1st class Api 1312 Restaurant Car WRp 3832 Panorama Car 2nd class Bp 2531 Panorama Car 2nd class Bp 2533	N
Matching accessories			
7074032	28-186	Glacier Express Short Coupler and Bellows Set (26 parts), for 7074031, 7074067 + 7074068	N
70DN63K4A	DN163K4A	DCC Decoder (DIGITRAX) Replacement Circuit Board, for KATO Ge 4/4 II and III, GEX	N
7074979	23-129	Glacier Express Platform Kit	N
7023245	23-245A	Swiss Alps Station 'Filisur'	N



7074979



7023245

The Rhaetian Railway® – More Popular Than Ever!

Reissue: Allegra and Bernina Express



7074071



7074061

NOCH Ref.	KATO Ref.	Description	Gauge
7074071	n.n.*	Allegra ABe 8/12, 3 pieces set	N
7074056	10-1655	'Bernina Express' Basic Set, 3 wagons	N
7074057	10-1656	'Bernina Express' Add-On Set, 4 wagons	N
Matching accessories			
7074061	05250-9	Bernina Express Souvenir Coach Panoramic coach Api 1301, incl. straight track Equipped with close couplers Without Arnold coupling	N
7074888	11-212	Interior Lighting, with LEDs, 6-pack	N
7074889	11-211	Interior Lighting, with LED, single pack	N
7074894	29-353	Function Decoder FR11 for Interior Lighting (only for Bernina coaches)	N

* Not yet determined at the time of the printing deadline.

NEW Allegra is being reissued and featuring a low-floor body structure, which enables the loco to be used in passenger service. Thanks to its speed of up to 100 km/h, this high-performance train is used on many Rhaetian Railway routes.

The Bernina Express is a sightseeing train which runs on the Albula and Bernina line between Chur (Switzerland) and Tirano (Italy) and which was recognised as a UNESCO World Heritage Site in 2008.

Expected release: Christmas 2023

Allegra Model Features:

- Allegra reissue with carriages, 3 pieces set
- Minimum radius: R150
- Maximum incline: 4%
- With dual-voltage system 11kV, 16 2/3Hz AC
- Equipped with close couplers (including replacement Arnold couplings)
- Alternating operating headlights
- DCC-ready (desired decoder can be soldered in)
- Interior lighting (optional) with KATO Standard Kit

Bernina Express Model Features:

- Add-On Set with Open Panorama Passenger Car B2096
- Outer dimensions of the carriages: 109.76 mm x 18 mm x 24.5 mm
- Minimum radius: R150
- Interior lighting option possible with KATO standard LED kit (special reflectors supplied in the carriage pack)
- Optional expansion possible with Function Decoder FR11
- Equipped with close couplers (including replacement Arnold couplings)



7074058, 7074056, 7074057

NOCH Ref.	KATO Ref.	Description	Gauge
7074058	5253	Open Panorama Passenger Car B2097	N
Matching accessories			
7024224	24-224	Passengers (1 standing figure, 5 sitting figures without legs)	N
7024225	24-225	Sitting passengers (without legs)	N

Reissue: Open Panorama Passenger Car

In summer, the open scenic carriages run between Davos and Filisur, St Moritz and Tirano, on the Arosa line, and as an adventure train in the Rhine Gorge. They are mainly connected to the Bernina Express, but also regular and special trains on the Bernina line.

Expected release: Christmas 2023

Model Features:

- Prototype B2097 from the group B2096–B2102 from 1990
- Labelling in German and Romansch
- Minimum radius: R150
- Equipped with close couplers (including replacement Arnold couplings)

Large or Small Radii? No Problem!

NEW These flexible tracks make it possible to recreate curves with a large or a small radius.

Already available at your local dealer.

NOCH Ref.	KATO Ref.	Description	Gauge
7078024	21-000	Flexible track, 808 mm (without bed)*	N
7078031	21-001	Flexible track with concrete sleepers, 808 mm*	N

*Only available in specialist shops

UNION PACIFIC Big Boy – The World's Biggest Steam Locomotive in Miniature



NEW The Union Pacific Railroad's (UP) class 4000 steam locomotive "Big Boy" is the world's largest and most powerful steam locomotive, with the world's only 2DD2 (4-8-8-4) wheel arrangement, a total weight of 507 tonnes and an overall length of 40 metres, including the tender.

The Big Boy's route extended across the entire American continent. The Big Boys were specially designed for use in the Rocky Mountains in order to cope effortlessly with the large and long gradients of sometimes 11.1% over 100 kilometres.

The loco has been active again since 2019, making it the largest operational steam locomotive today.

The KATO model is a completely new construction that has two five-pole motors with a flywheel, a change of light and a very detailed look.

Expected release:

Analogue version: spring 2023

DCC + DCC & sound: summer 2023

NOCH Ref.	KATO Ref.	Description	Gauge
701264014	126-4014	Big Boy Steam Locomotive Union Pacific No. 4014	N
701264014DCC	126-4014-DCC	Big Boy Steam Locomotive Union Pacific No. 4014 with DCC	N
701264014S	126-4014-S	Big Boy Steam Locomotive No. 4014 Union Pacific with Soundtraxx DCC & Sound Installed	N

Model Features:

- Minimum radius thanks to articulated frame: 282 mm (11")
- Synchronised, coreless dual-motor drive: combines the power of two individual motors
- Electric pickup shoes on coach body and tender
- The metal frame and the additional weights in the body details ensure precise balance and unparalleled traction
- Exquisitely formed details that replicate the extensive pipe details, which extend over the entire length of the boiler
- Illuminated, deck-mounted headlamp
- Change of light and illuminated number plates
- Modern 2021 tour design

You can find all the information in English on the following KATO webpage: www.kato-start.com/bigboy-en

Ina Weiland
Partner Brands

Both the original and the replica of the Big Boy locomotive fascinate me. How effortlessly it crosses the entire continent and conquers the Rocky Mountains is incredible.



Thanks to a special articulated mechanism, the Big Boy can manoeuvre around curves with a radius of 11", just like the Union Pacific FEF-3 and GS-4 by Kato USA

Model: colours are subject to change

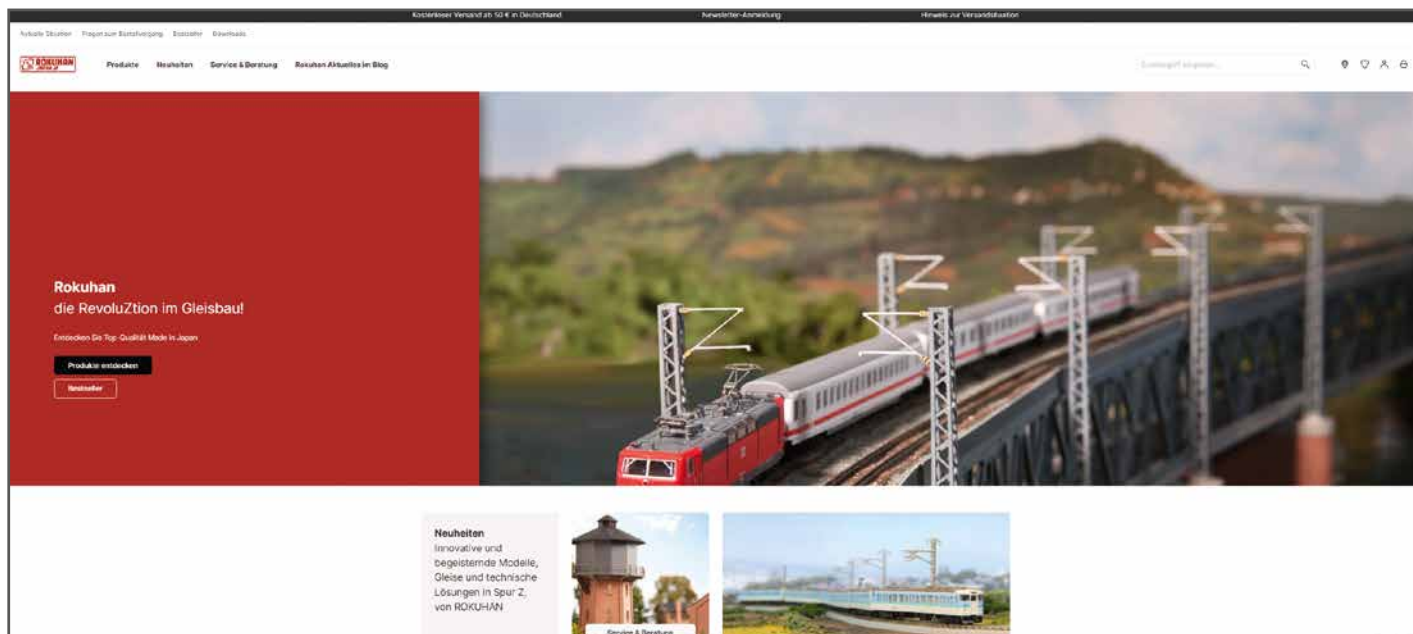

ROKUHAN News

Here you find all news, campaigns and special product posts:
www.rokuhan.de/rokuhan-aktuelles-im-blog/

Service & Advice

Posts on ROKUHAN track geometry, application tips, technical data and track plans are waiting to be read and used:
www.rokuhan.de/service-beratung/

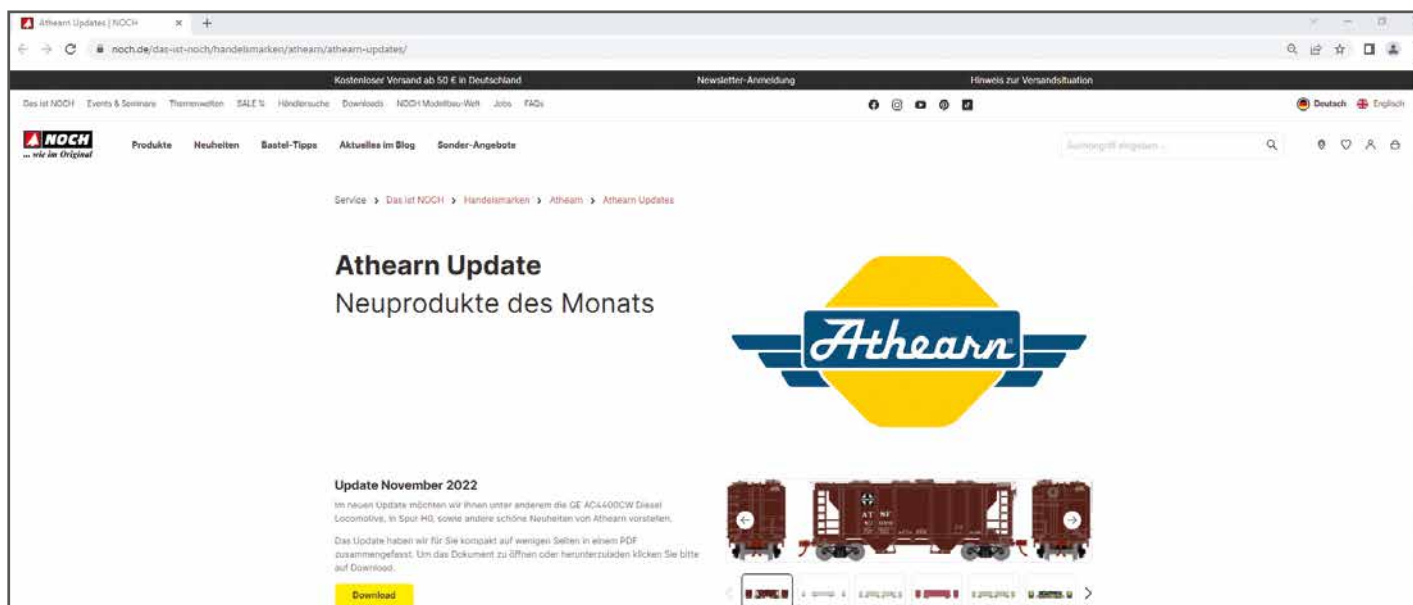

New Athearn Models every month: stay up to date!

Athearn's monthly novelties can only be ordered from retailers within a very limited period of time and are available for delivery after approximately one year. The latest news and information on the models can be found at:
www.noch.de/das-ist-noch/handelsmarken/athearn/athearn-updates/

Note: Please order your desired model from the dealer of your choice. For Athearn items, we only accept pre-orders within the time period stated in the newsletter.

Our Services for You

For over 110 years, NOCH has been your no. 1 partner for all aspects of model landscaping. We do everything we can to provide you with comprehensive information and support you in making your craft project a success. That's why we have developed a multitude of products and services with one goal in mind: we want you to have fun with your hobby with the help of our products and be enthusiastic about your modelling project.

Guidebooks

Do you want to get informed or implement a specific craft project? We have created a small range of full-colour magazines on various model landscaping topics. Order the Easy-Track Guidebook, the Family Hobby Model Railway Guidebook or the St Sebastian Guidebook at www.noch.com/model-railroad-magazines and pick up inspiration for your project. You can get a 20% discount with this discount code*: **MAGAZIN20**



Catalogues

On over 420 pages, you'll discover everything on the topics of terrain and track construction, bridges, portals, walls, landscape design, adding greenery and flocking, winter landscapes, trees and bushes, buildings, figures and decorations, and much more. In the catalogue, you'll find countless craft tips and tricks of the trade. The NOCH Catalogue will become your indispensable guide on all topics related to model landscaping. Order the NOCH Catalogue for 2023/24 online at www.noch.com/noch-model-landscaping-catalogue. You can get a 20% discount with this discount code*: **KATALOG20**



Modelling World in Wangen im Allgäu

Do you want to get to know us personally and get some advice? Then come and visit us in Wangen im Allgäu. At NOCH Modelling World, our colleagues will answer your questions and be able to recommend the best products for your projects. A shopping experience for every modelling fan. You'll find info and opening hours at www.noch.com/service/noch-modelling-world/



Trade Fairs

We're also happy to come to a place near you. Every year, NOCH has a stall at the most important national and international model railway fairs. Visit us and let yourself be inspired by our trade fair layouts. You can find a current overview of trade fairs here: www.noch.com/service/events-seminars/



Model Landscaping Seminars

Do you want to learn model landscaping techniques live? Visit one of our seminars at our factory in Wangen im Allgäu. We offer seminars on various handicraft topics. Come alone (Pro Seminar), with your child or grandchild (Parent & Child Seminar) or as a modelling team (Team Seminar). You can find the entire range of seminars and booking options at www.noch.com/service/events-seminars/. The seminars are held in German only.

Home Academy Webinar

Do you want to learn model landscaping techniques from the comfort of your home? Not a problem thanks to the free "Home Academy" webinar on our YouTube channel. In five episodes guided by NOCH Managing Director Sebastian Topp, you'll learn the most important model landscaping techniques. You'll find the NOCH Home Academy here: www.noch.com/products/theme-worlds/holiday-in-the-mountains



Social Media

Are you looking for tips, tricks, comprehensive information and suggestions? Over 40,000 subscribers can't be wrong. Visit NOCH's YouTube channel and get inspired by hundreds of videos. You can find our YouTube channel here: www.noch.de/YouTube. Follow us on Facebook, Instagram and TikTok to be kept in the loop: www.facebook.com/NOCH.Modell/ · www.instagram.com/noch_miniature/ · www.tiktok.com/@noch_miniature



*The codes are valid until 30th September 2023!

NOCH symbols



Gauges



Your NOCH Dealer:



... wie im Original

NOCH GmbH & Co. KG
Lindauer Straße 49
D-88239 Wangen im Allgäu
Tel.: +49 - 75 22 - 97 80-0
Fax: +49 - 75 22 - 97 80-80
E-Mail: info@noch.de
www.noch.de · www.noch.com
 www.noch.de/facebook
 www.noch.de/youtube